

FRAME STUDIOS

Legendary director Martin Campbell (James Bond Goldeneye / Casino Royale) in King's HANGAR (Frame Studios) during principal photography of THE PROTEGE, starring Michael Keaton and Samuel L. Jackson / Lionsgate/Millennium Media / 2020)



FRAME STUDIOS





1 King's HANGAR. (4200 sqm)

2 Exterior unload platform

3 Period City Backlot A (3200sqm)

4 Backlot B (2900 sqm)

5 Backlot C (1200 sqm)

6 Props Warehouse (314 sqm)

7 Workshop (371 sqm)

8 STAGE DEUX (421 sqm)
In preparation

9 Warehouse (366 sqm)

10 Props Atelier (197qm)

11 Furniture warehouse (120 sqm)

12 Basecamp warehouse (190 sqm)

13 Offices (190 sqm)

14 Platforms/ Parking (2000sqm)

15 Unit Camp / Parking (2200 sqm)

F R A M E
S T U D I O S

A woman in a dark dress is walking away from the camera on a gravel path at night. She is carrying a basket in her left hand. In the background, there is a large, multi-story building with arched windows and a balcony, illuminated by warm lights. The scene is surrounded by trees and foliage, creating a moody and atmospheric setting.

FRAME FILM

We had a simple vision.

A film studio production complex designed by filmmakers for filmmakers.
The right space at the right distance to Bucharest.
Versatile, accesible, no overheads, no hidden costs.
Bare minimum to service productions.
One handshake.

And here it is.

Bring us your storyboard, your demanding director and your toughest line-producer.

We'll pencil the set, price the week, and prove the numbers before you pack a single flight-case.

We designed it like a dream.

A big Hollywood like studio complex in the heart of Eastern Europe, at the gates of Orient.

By coupling Romania's generous new cash-rebate scheme with its highly skilled, cost-efficient crews, we planned forging a production hub that can compete with any in the world.



K I N G ' S H A N G A R STUDIO

We started with a smart conversion of the former Danubiana factory, an old industrial space located in the southern part of Bucharest. The adaptive reuse of the structure, now referred to as The King's Hangar, has led to the creation of the largest soundstage in Romania. Spanning a vast **4200** square meters, the soundstage also ranks among the most extensive in Central and Eastern Europe.

Equipped with all necessary facilities for film production, the studio also features an additional 600 square meters of production offices in the semi-basement of the hangar. Conveniently located just 15 minutes south of Bucharest's city center, King's Hangar Studio is easily accessible and boasts a 15000 square meter backlot adjacent to the hangar,†

F R A M E
S T U D I O S



FRAME STUDIOS

KINGs HANGAR 4200sqm

60x70m 9.5m height

Here's the game changer: Frame Studios sits just 20 minutes from downtown Bucharest—close enough for a lunch-hour dash, yet outside the congestion zone. Everything a runaway production could ask for radiates from that sweet spot

Prime access. Two turns off the capital's ring road; 35 minutes to Henri-Coandă International; container trucks roll straight from the A-3 motorway to our dock doors—no low-clearance bridges, no city permits, no headaches.

The region's flagship stage. A cavernous, clear-span soundstage—and 4200 sqm. the largest in Eastern Europe—with 9.5 grid to 16 m height, gas heating and 4 MW of dedicated power. Hang a full castle interior, flood it for a water scene, or park an airliner inside.



STAGE DEUX 420sqm

currently in preparation

Virtual Production stage

8.5m height

18x24m



Next-gen storytelling on tap. We are expanding to STAGE DEUX. A boutique virtual-production stage (LED volume + motion-capture) comes online Q4, giving directors real-time parallax backdrops without leaving the lot.

Backlot that breathes. 2 hectare of grass serviced open ground—ready for a period city, a medieval fortress, a sci-fi colony, or a smoking crater. Utility trenches, water hookups, and perimeter roads are already in place, so set construction races ahead instead of burrowing for power cables.

In short: big, future-proof stages, a build-anything backlot, and logistics that behave themselves—all minutes from Romania's creative capital.

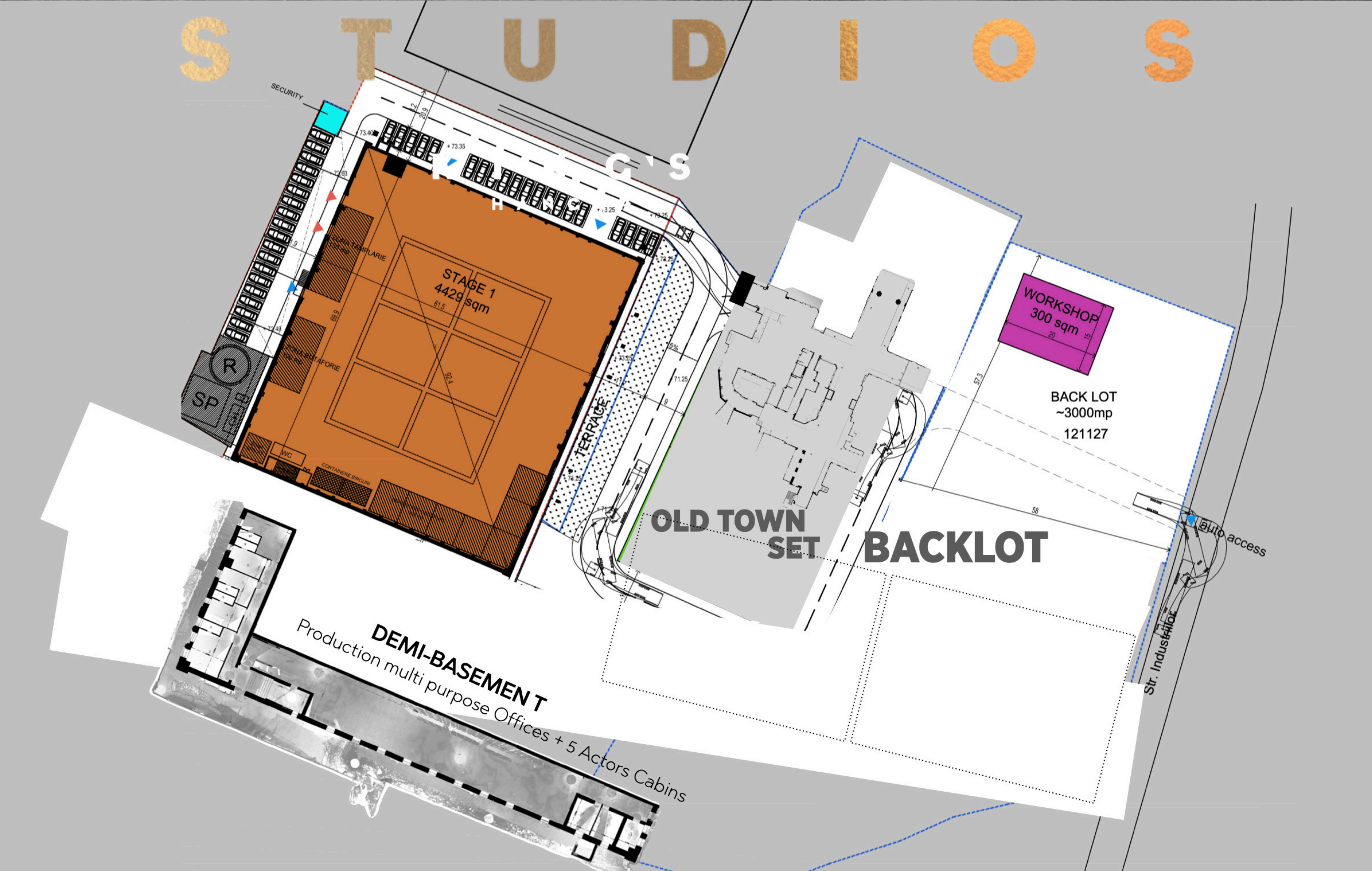
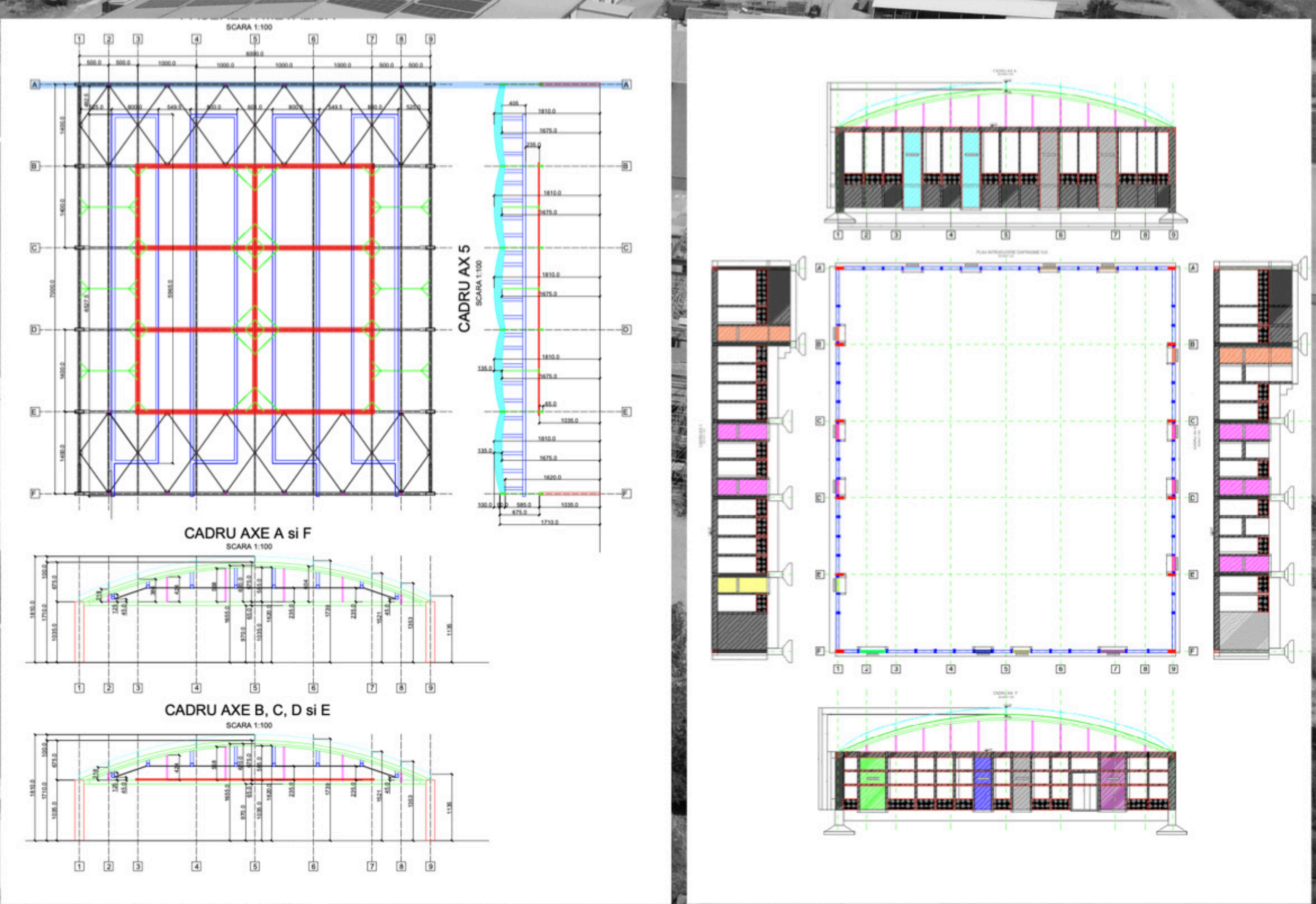
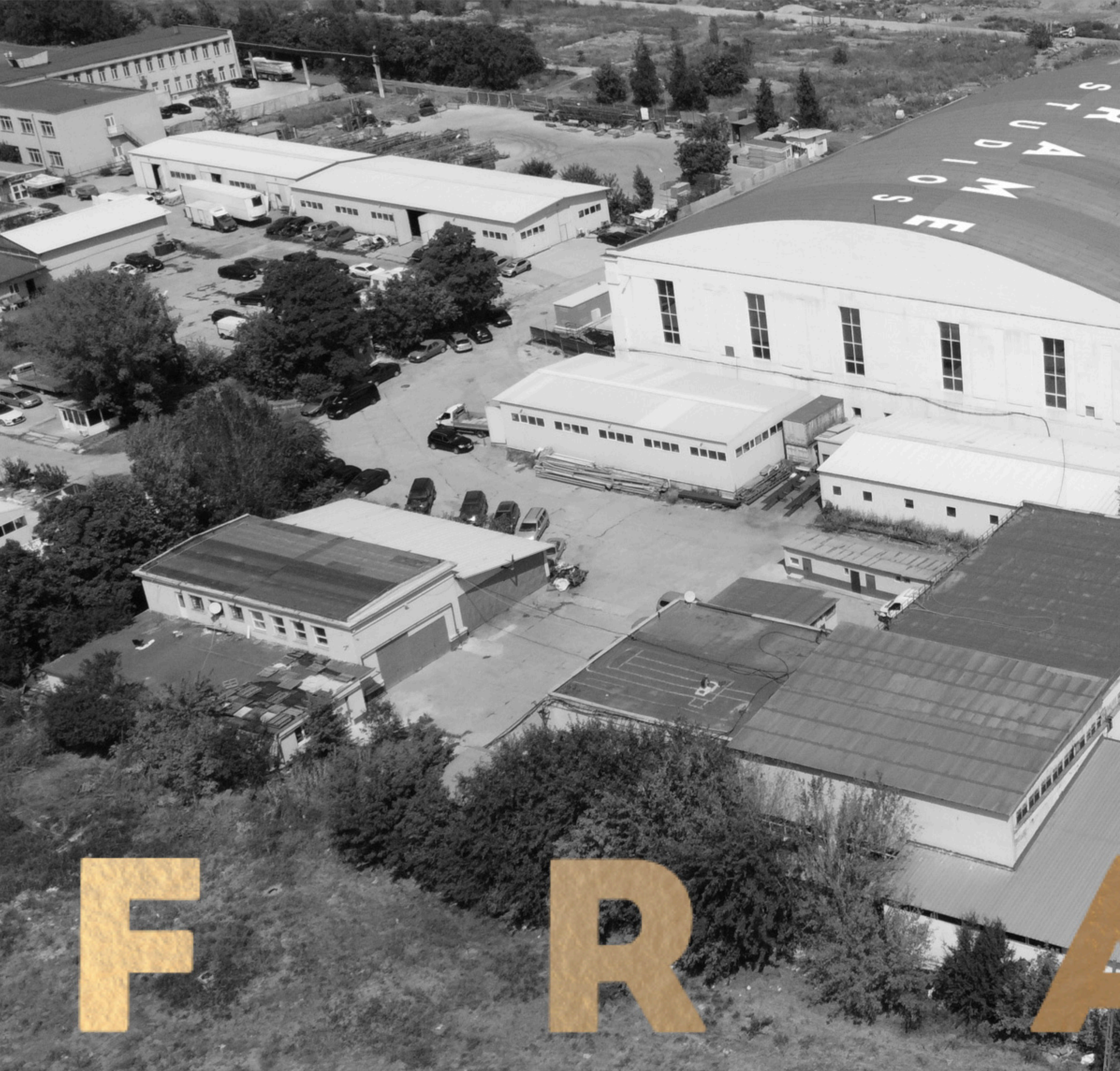

A quick tour

through our site's
checkered and slightly cinematic history

Wartime Runway, Royal Drama. During World War II the grounds served as a crown jewel of the Romanian Royal Air Force; King Michael himself kept his personal aircraft in the main hangar.

Great Escape, 1944. After the Ploiești raids, a flock of B-17 Flying Fortresses touched down here and whisked away some 1,700 American POWs—an episode worthy of its own war movie.

From Jets to Treads. The Red Army stripped the airfield after the war and repurposed it into one of the Soviet bloc's largest truck-tire plants, topped off with the now-iconic, barrel-roofed warehouse that still dominates the site.

Post-Communist Plot Twist. The factory went bankrupt in the '90s, leaving behind rust, pigeons, and a killer backdrop. Cue Hollywood: a location scout took one look at the crumbling grandeur and said, "Roll camera!"—turning the forgotten complex into an unlikely movie set.

From royal runways to rubber tires to red-carpet close-ups, this patch of land has never stopped reinventing itself—perfect training for its next role as a world-class film studio.



King Michael of Romania in his plane



Jonah Hill and Miles Teller as American arms dealers Efraim Diveroli and David Packouz, in **War Dogs**, (2016), directed by Todd Phillips / Warner Bros. Pictures. In this memorable scene, shot in the ruined tire factory of Danubiana, the duo are buying Cold War-era firearms from a weapons depot in Albania.



F R A M E
S T U D I O S

set construction

At its essence, a film studio is defined by the sets it can bring to life—the spaces where imagination takes physical form and stories step off the page onto the soundstage.

Over the past twenty years, Romania's set-building craft has reached world-class heights: the studio team raised an entire 19th-century frontier town for DJANGO the series amid the volcanic landscapes of Racoș, Transylvania. Frame Studios is determined to become the premier destination for productions that demand awe-inspiring environments, marrying visionary design with the unmatched skill of our local artisans.



New Babylon

set , designed by
Paki Meduri fo
Django - the
series / Cattleya/
Atlantique
Productions/
Frame Film

F R A M E
S T U D I O S



OLT TOWN BACKLOT SET

WE WERE THE LUCKY ONES

F R A M E

S T U D I O S

Created for the Disney+/Hulu event series **WE WERE THE LUCKY ONES** in 2023, the old town backlot set imagined by James Merifield, the series production designer, with its intricate maze of streets, alleys and corridors, depicted a neighborhood in an eastern european city in early 1940.



WE WERE THE LUCKY ONES

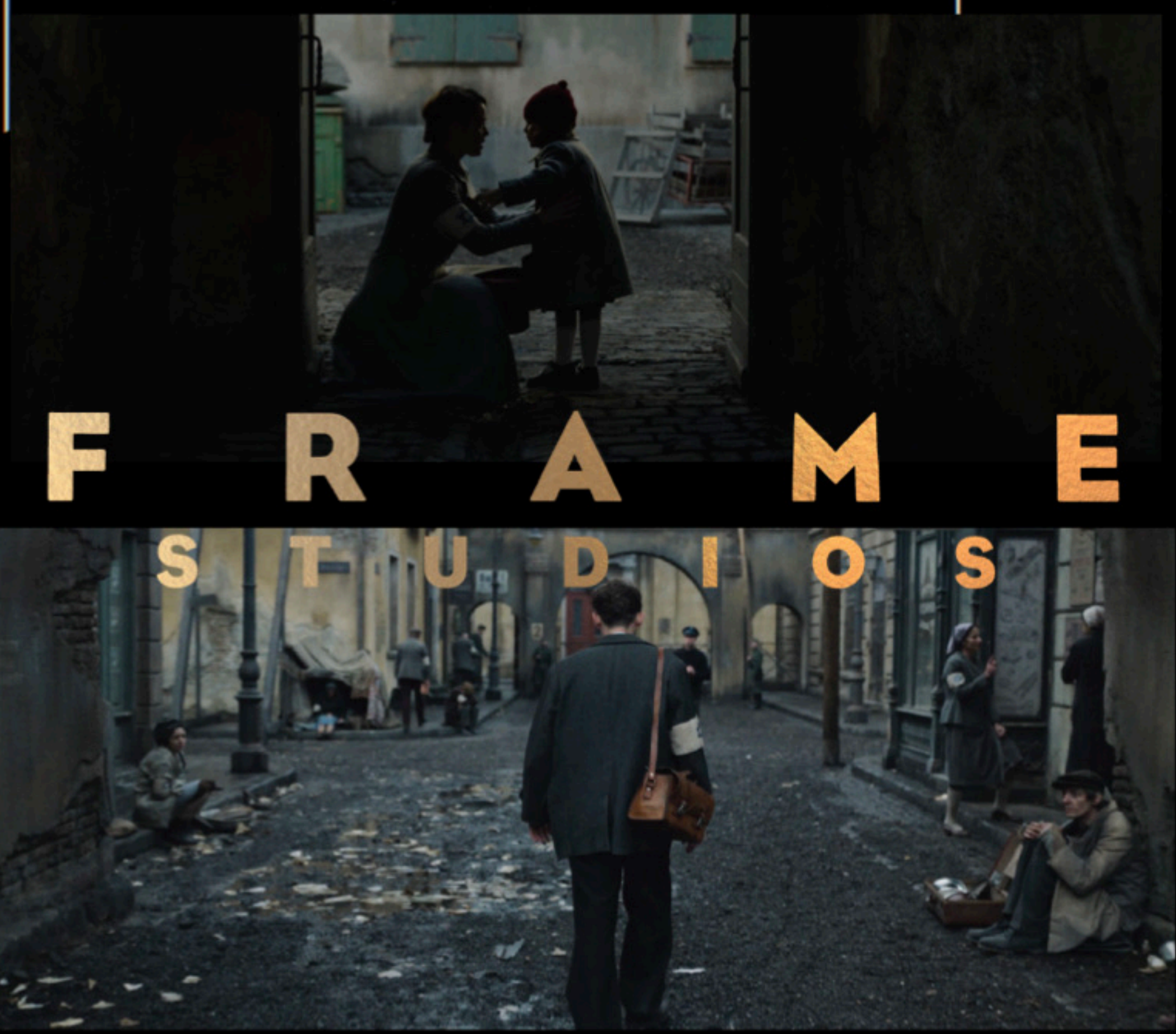



Currently on stage, the apartment complex of SCARA B, the tv series, 5 fully furnished flats.



FRAME
STUDIOS





To keep productions nimble, Frame Studios operates a dedicated start-trailer fleet—four purpose-mobile units that roll wherever your schedule demands.

Why it matters

Luxury but affordable - they are simply the best available in Romania of any production services

Mobility equals momentum. Whether you're shooting back-lot, deep forest, or downtown Bucharest, the fleet deploys in under an hour—no time lost shuttling departments back to base.

WHITE HAWK

WHITE HAWK is a single trailer, it has premium interior, one bedroom, one big living room combined with the kitchen, one round couch, good for office.

F R A M E
S T U D I O S

RADIANCE

RADIANCE is a single trailer that has a comfortable living room and bedroom. It has one toilet with shower and in the living room it has 2 small sofa's with a table in the middle which can be used also as an office





SURVEYOR

SURVEYOR is a single trailer that has one round couch with a table in the middle and a comfy armchair. It has one bedroom and one bathroom

FRAME STUDIOS



Self-contained and off-grid. Each trailer carries its own power, climate control, and network uplink, so remote locations stay fully functional—even before mains hookups arrive. From first call sheet to final take, **Surveyor, White Hawk, Radiance, and Falcon** keep your production agile, comfortable, and ready to fly

FALCON

FALCON is a single trailer that has one bedroom, one bathroom and one big living room with 1 big sofa and other 2 with a table to use as an office. Is a great place for rest. Photos attached.



Michael Keaton as the
super spy "Rembrandt" in
"The Protégé", directed by
Martin Campbell /
LIONSGATE / Millenium
Media / Frame Film
Bucharest 2021

Take a look

into some works made in Frame Studios .
Every day couldn't have been the perfect
shooting day, but for Samuel Jackson,
Michael Keaton and Maggie Q . it just
was in the international spy thriller *The
Protégé*, directed by Martin Campbell
[James Bond *GoldenEye* and *Casino
Royale*] / produced for Lionsgate/
Millenium Media

<https://vimeo.com/816460754>

FRAME STUDIOS

Or you could just encounter on set fearsome creatures played by
Wade Briggs and Frida Gustavsson, in the italian supernatural movie
Dampyr, directed by Ricardo Chemello, produced by Eagle Pictures/
Bonelli Editore and Brandon Box/ distributed by Sony Pictures.

<https://vimeo.com/858631105>

Or roam the streets of the fabulous New Babylon western town set
in **Django**, the major european television mini series produced by
Cattleya , Atlantique Productions and Frame Film for Canal+ and Sky
Studios, featuring Mathias Schoenaerts, Noomi Rapace, Lisa Vicari and
Nicholas Pinnock, directed by Francesca Comencini, David Evans and
Enrique Maria Artale.



...and we were the lucky ones to host Hulu/Disney+'s acclaimed
limited series **We Were The Lucky Ones** [disney+,Hulu]. Filming in
Bucharest, the production transformed Frame Studios' back-lot into
1930s Lvov, and wartime Poland .

[https://youtu.be/SDmDoAw431A?
si=3DUYIXCzW33WZlwb](https://youtu.be/SDmDoAw431A?si=3DUYIXCzW33WZlwb)



